

15 Madeira Place

Ref No: 3578

Torquay, Devon, TQ2 5RD



The Site of a Former Cottage (Known as 15 Madeira Place)

Currently Used as Three Car Parking Spaces

In a Convenient Town Centre Location

Close to Many Local Business Occupiers

Two Spaces Currently Let at £50 PCM (Each) - Available with Vacant Possession

Offers in the Region of £21,000

Interested in this property?
T.01803 21 20 21 bettesworths.co.uk



15 Madeira Place

Torquay, Devon, TQ2 5RD

The plots may also be available for purchase as individual spaces by negotiation, please contact Agent's for further information.

SPACE 1	WIDTH 9' 8" (2.94m)	DEPTH 22' 0" (6.71m)
SPACE 2	WIDTH 10' 0" (3.06m)	DEPTH 18' 1" (5.50m)
SPACE 3	WIDTH 9' 10" (2.99m)	DEPTH 18' 1" (5.50m)
TOTAL WIDTH	30' 0" (9.14m)	

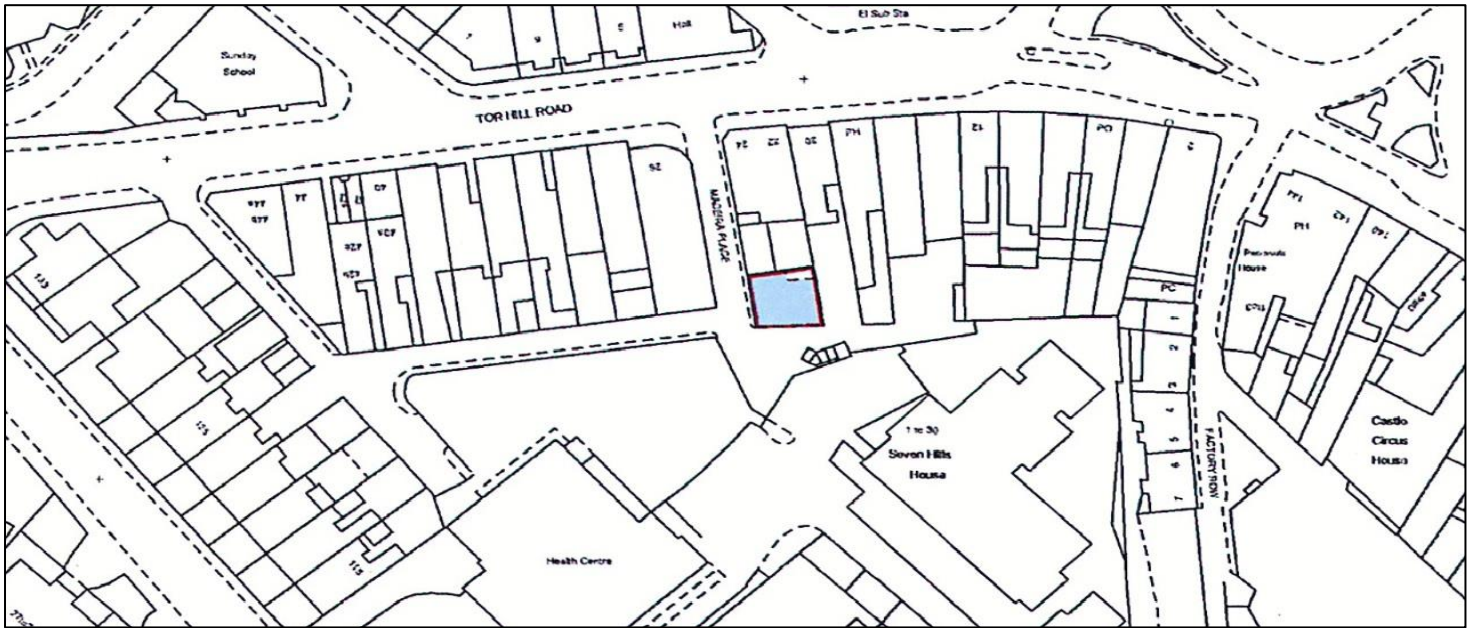

www.bettesworths.co.uk
29/30 Fleet Street
Torquay
Devon
TQ1 1BB



IMPORTANT NOTE: Messrs Bettesworths for themselves and for the vendors or lessors of this property whose agents they are give notice that: (i) the particulars are produced in good faith, are set out as a general guide only and do not constitute any part of a contract; (ii) no person in the employment of Messrs Bettesworths has any authority to make or give representation or warranty whatever in relation to this property. The fittings, equipment and services have not been tested by the agents.

Interested in this property?
T.01803 21 20 21 bettesworths.co.uk

